



**GLOBE** TEST EQUIPMENT B.V.

---

Datasheet APU SC10-5 LP Air Driven Pressure Test Unit

---



## Air Driven High Pressure Test Unit APU SC10-5 LP

The APU SC10-5 air driven high pressure systems are specially designed for test pressures up to 630 bar (9135 psi) at 7 bar (100 psi) air drive pressure. Commonly used when high pressure is used in a mobile situation. The main energy sources of the high pressure systems are air pressure and fluid.

The frame, valves and tubing used in the APU SC10-5 are made of stainless steel and are therefore of a very high quality. Because the system is designed and constructed to be maintenance friendly, the unit has a long lifetime. High pressure testing of many different types of fluids is no problem for our units.



### Features

- Portable design, compact and less noise
- Reliable, long lifetime, maintenance friendly
- Hydraulic components and frame made of stainless steel
- A test pressure of 5 bar (72 psi) up to 630 bar (9135 psi). Test pressure of 2 bar (29 psi) up to 630 bar (9135 psi) possible with low pressure option
- Designed for water, oil, emulsion or other fluids
- Pressure hold without air consumption and auto start
- Min. air pressure needed for startup is approx. 1 bar (14,5 psi), low pressure option available allowing the pump to start up at approx. 0.4 bar (5,8 psi)
- Flow rate and outlet test pressure can be regulated easily and smooth through the air pressure regulator on the inlet
- Special wishes are optional such as a recorder, tank and extra special valves etc.

### Suitable applications

- Static or burst testing of hoses, tubing and valves
- Testing of pressure vessels or hydro systems
- Use as an energy source for static or mobile test systems
- Impregnation systems
- Molding systems
- Hydraulic press systems
- Bolt cutter
- Tensioning systems or similar
- Hydrostatic testing – valves, tanks, pressure vessels, pressure switches, hoses, pipes and tubing, cylinders, gas bottles
- Burst and cycle fatigue testing
- Lifting and jacking – lifting tables, scissor jack lift, beam jacking and aircraft jacking
- Hydraulic operation – clamping devices
- Leak testing

### Delivered with

- Filter, pressure regulator, oiler and gauge for the air inlet pressure
- Ball valve for pump on/off
- Outlet test pressure with a stainless steel gauge – glyc. filled
- Outlet test pressure with a stainless steel pressure release valve
- Outlet test pressure with a stainless steel manifold block



**Technical Specifications**

Type	Ratio	Max inlet air-pressure	Outlet test pressure	Cm3 / Stroke	Max. Liter/min. (free flow)
APU SC10-5-5	5:1	7 bar (100 psi)	35 bar (464 psi)	90	30
APU SC10-5-10	10:1	7 bar (100 psi)	70 bar (1015 psi)	42	23
APU SC10-5-12	12:1	7 bar (100 psi)	84 bar (1218 psi)	36	18
APU SC10-5-20	20:1	7 bar (100 psi)	140 bar (2030 psi)	34	12
APU SC10-5-25	25:1	7 bar (100 psi)	175 bar (2610 psi)	16	9
APU SC10-5-30	30:1	7 bar (100 psi)	210 bar (3045 psi)	14	7.5
APU SC10-5-35	35:1	7 bar (100 psi)	245 bar (3553 psi)	12	6
APU SC10-5-55	55:1	7 bar (100 psi)	385 bar (5583 psi)	7,6	3.5
APU SC10-5-70	70:1	7 bar (100 psi)	490 bar (7107 psi)	6,29	3
APU SC10-5-85	85:1	7 bar (100 psi)	595 bar (8629 psi)	5	3
APU SC10-5-105	105:1	7 bar (100 psi)	630 bar (9135 psi)	4	1,9

**Dimensions in mm**

Length	Width	Height	Weight kg
500	300	370	approx. 25

Type	Air inlet connection	Fluid inlet connection (System)	Outlet connection (System)
APU SC10-5-5	G3/8"	1/2" BSP F	1/2" NPT F
APU SC10-5-10	G3/8"	1/2" BSP F	1/2" NPT F
APU SC10-5-12	G3/8"	1/2" BSP F	1/2" NPT F
APU SC10-5-20	G3/8"	1/2" BSP F	1/2" NPT F
APU SC10-5-25	G3/8"	1/2" BSP F	1/2" NPT F
APU SC10-5-30	G3/8"	1/2" BSP F	1/2" NPT F
APU SC10-5-35	G3/8"	1/2" BSP F	1/2" NPT F
APU SC10-5-55	G3/8"	1/2" BSP F	1/2" NPT F
APU SC10-5-70	G3/8"	1/2" BSP F	1/2" NPT F
APU SC10-5-85	G3/8"	1/2" BSP F	1/2" NPT F
APU SC10-5-105	G3/8"	1/2" BSP F	1/2" NPT F

Technical specifications are subject to change if necessary

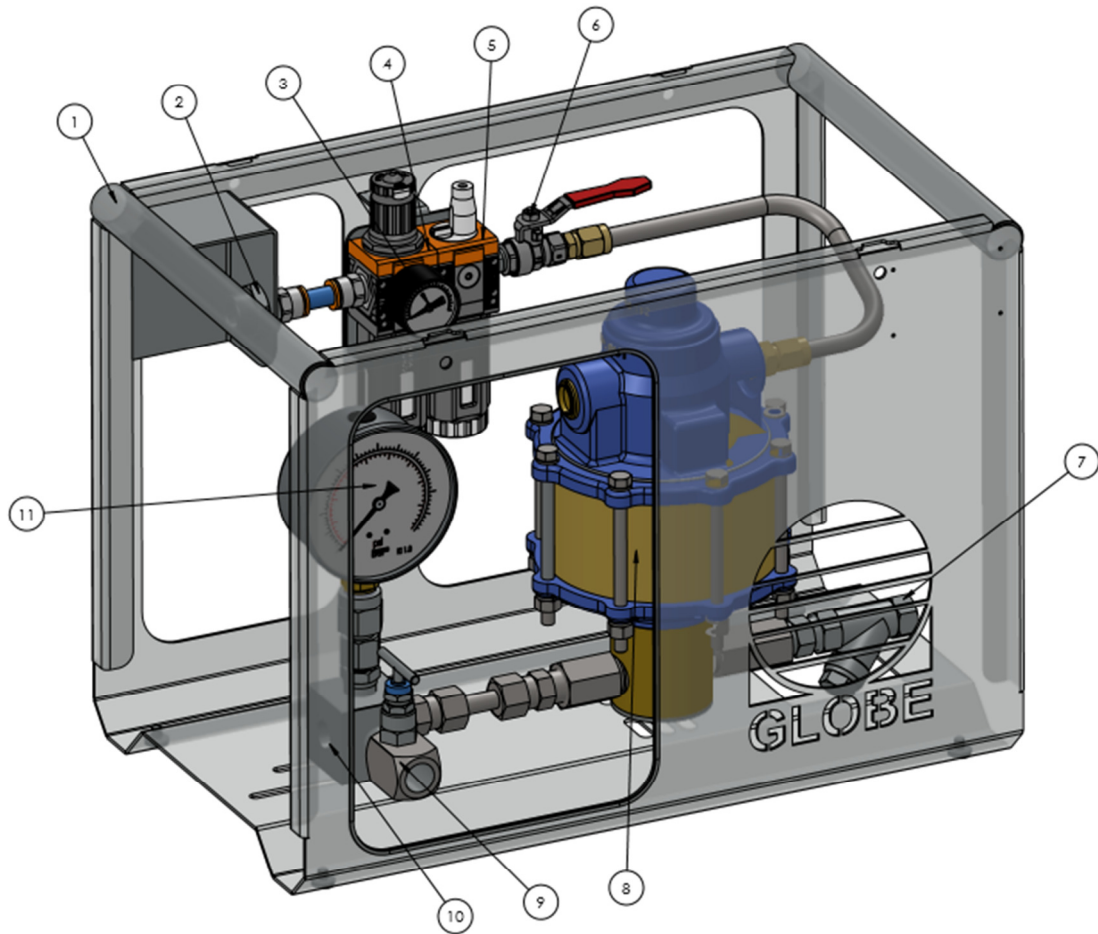

**Parts/Construction**

Item	Qty.	Description	Material
1	1	Frame 10 – 5 standard	Stainless steel
2	1	Air inlet connection G3/8"	Brass nickel-plated
3	1	Pressure gauge 0-10 bar (0-145 psi)	Brass nickel-plated
4	1	Filter/Reducer	Technopolymer and brass nickel-plated
5	1	Lubricator	Technopolymer and brass nickel-plated
6	1	Ball valve for pump on/off	Brass nickel-plated
7	1	Fluid inlet connection on filter 1" BSP	Stainless steel
8	1	SC10-5 Test Pump	Alu/Br (stainless steel optional)
9	1	Pressure release valve 1/2" NPT F	Stainless steel
10	1	Pressure outlet connection 1/2" NPT F	Stainless steel
11	1	Pressure gauge Suitable for max. Pressure	Stainless steel