



**GLOBE** TEST EQUIPMENT B.V.

---

Datasheet APU SC10-4 LP Air Driven Pressure Test Unit

---



## Air Driven High Pressure Test Unit APU SC10-4 LP

The APU SC10-5 air driven high pressure systems are specially designed for test pressures up to 630 bar (9135 psi) at 7 bar (100 psi) air drive pressure. Commonly used when high pressure is used in a mobile situation. The main energy sources of the high pressure systems are air pressure and fluid.

The frame, valves and tubing used in the APU SC10-4 are made of stainless steel and are therefore of a very high quality. Because the system is designed and constructed to be maintenance friendly, the unit has a long lifetime. High pressure testing of many different types of fluids is no problem for our units.



### Features

- Portable design, compact and less noise
- Reliable, long lifetime, maintenance friendly
- Hydraulic components and frame made of stainless steel
- A test pressure of 5 bar (72 psi) up to 630 bar (9135 psi). Test pressure of 2 bar (29 psi) up to 630 bar (9135 psi) possible with low pressure option
- Designed for water, oil, emulsion or other fluids
- Pressure hold without air consumption and auto start
- Min. air pressure needed for startup is approx. 1 bar (14,5 psi), low pressure option available allowing the pump to start up at approx. 0.4 bar (5,8 psi)
- Flow rate and outlet test pressure can be regulated easily and smooth through the air pressure regulator on the inlet
- Special wishes are optional such as a recorder, tank and extra special valves etc.

### Suitable applications

- Static or burst testing of hoses, tubing and valves
- Testing of pressure vessels or hydro systems
- Use as an energy source for static or mobile test systems
- Impregnation systems
- Molding systems
- Hydraulic press systems
- Bolt cutter
- Tensioning systems or similar
- Hydrostatic testing – valves, tanks, pressure vessels, pressure switches, hoses, pipes and tubing, cylinders, gas bottles
- Burst and cycle fatigue testing
- Lifting and jacking – lifting tables, scissor jack lift, beam jacking and aircraft jacking
- Hydraulic operation – clamping devices
- Leak testing

### Delivered with

- Filter, pressure regulator, oiler and gauge for the air inlet pressure
- Ball valve for pump on/off
- Outlet test pressure with a stainless steel gauge – glyc. filled
- Outlet test pressure with a stainless steel pressure release valve
- Outlet test pressure with a stainless steel manifold block

### Technical Specifications

| Type           | Ratio | Max inlet air-pressure | Outlet test pressure  | Cm3 / Stroke | Max. Liter/min. (free flow) |
|----------------|-------|------------------------|-----------------------|--------------|-----------------------------|
| APU SC10-4-5   | 5:1   | 7 bar<br>(100 psi)     | 35 bar<br>(464 psi)   | 42           | 12                          |
| APU SC10-4-10  | 10:1  | 7 bar<br>(100 psi)     | 70 bar<br>(1015 psi)  | 23           | 8,5                         |
| APU SC10-4-15  | 15:1  | 7 bar<br>(100 psi)     | 105 bar<br>(1522 psi) | 12           | 4,7                         |
| APU SC10-4-30  | 30:1  | 7 bar<br>(100 psi)     | 210 bar<br>(3045 psi) | 8            | 2,7                         |
| APU SC10-4-35  | 35:1  | 7 bar<br>(100 psi)     | 245 bar<br>(3553 psi) | 6            | 2,6                         |
| APU SC10-4-55  | 55:1  | 7 bar<br>(100 psi)     | 385 bar<br>(5582 psi) | 4            | 1,6                         |
| APU SC10-4-100 | 100:1 | 7 bar<br>(100 psi)     | 630 bar<br>(9135 psi) | 2            | 0,75                        |

### Dimensions in mm

| Length | Width | Height | Weight kg  |
|--------|-------|--------|------------|
| 400    | 264   | 325    | approx. 15 |

| Type           | Air inlet connection | Fluid inlet connection (System) | Outlet connection (System) |
|----------------|----------------------|---------------------------------|----------------------------|
| APU SC10-4-5   | G1/4"                | 1/2" BSP F                      | 1/2" NPT F                 |
| APU SC10-4-10  | G1/4"                | 1/2" BSP F                      | 1/2" NPT F                 |
| APU SC10-4-15  | G1/4"                | 1/2" BSP F                      | 1/2" NPT F                 |
| APU SC10-4-30  | G1/4"                | 1/2" BSP F                      | 1/2" NPT F                 |
| APU SC10-4-35  | G1/4"                | 1/2" BSP F                      | 1/2" NPT F                 |
| APU SC10-4-55  | G1/4"                | 1/2" BSP F                      | 1/2" NPT F                 |
| APU SC10-4-100 | G1/4"                | 1/2" BSP F                      | 1/2" NPT F                 |

Technical specifications are subject to change if necessary

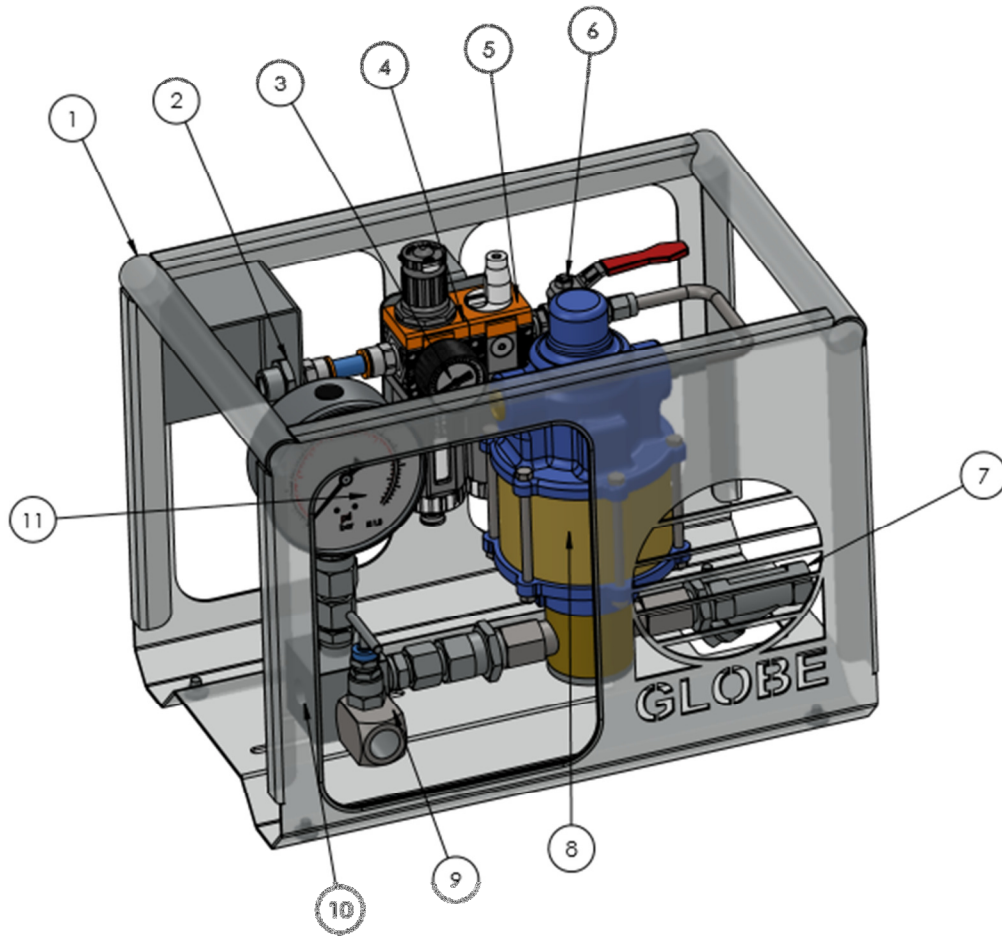

**Parts/Construction**

| Item | Qty. | Description                               | Material                              |
|------|------|---|---------------------------------------|
| 1    | 1    | Frame 10 – 4 standard                     | Stainless steel                       |
| 2    | 1    | Air inlet connection G1/4"                | Brass nickel-plated                   |
| 3    | 1    | Pressure gauge 0-10 bar (0-145 psi)       | Brass nickel-plated                   |
| 4    | 1    | Filter/Reducer                            | Technopolymer and brass nickel-plated |
| 5    | 1    | Lubricator                                | Technopolymer and brass nickel-plated |
| 6    | 1    | Ball valve for pump on/off                | Brass nickel-plated                   |
| 7    | 1    | Fluid inlet filter                        | Stainless steel                       |
| 8    | 1    | SC10-4 Test Pump                          | Alu/Br<br>(stainless steel optional)  |
| 9    | 1    | Pressure release valve 1/2" NPT F         | Stainless steel                       |
| 10   | 1    | Pressure outlet connection 1/2" NPT F     | Stainless steel                       |
| 11   | 1    | Pressure gauge Suitable for max. Pressure | Stainless steel                       |